



100MA MOBILE X-RAY

This Mobile X-Ray is a multi-functional portable X-ray machine with small size, light weight and smart function. It includes 5.6 kw X-ray power unit. It can fulfill various outreach and field portable mobile X-ray application scenarios.



KEY FEATURES

- 5kW Monobloc (125kV/320mAs)
- AC line powered
- Free Stop Tube Arm
- 360° Lateral Moving Arm
- 360° Rotational Wheels

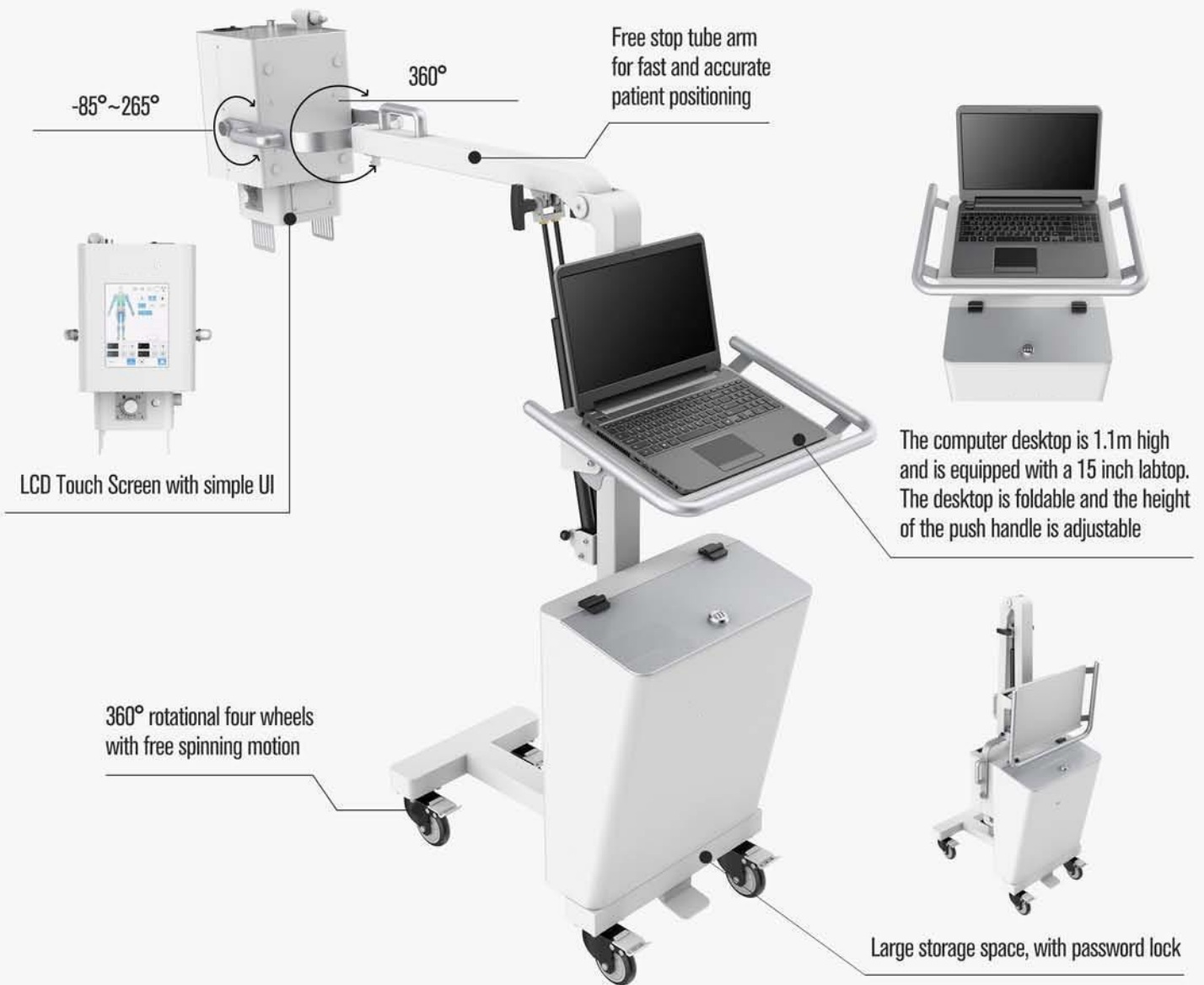

Mobile unit

Tube Arm Rotation	360°
Tube Rotation	-85°~265°
SID to Floor	2000mm Max
Size	795mm×550mm×1450mm
Net Weight	70kg

Overhead LCD Screen Console

- Selectable 87 APR (29 location × 3 position) ;Three body types
- Focus selection
- KV, Ma, MAS and MS parameter selection
- MA / MS and MAS mode selection
- Exposure status indication
- Error code display

MONOBLOC SPECIFICATIONS

Output Power	5.6kW
kV range	40~125kV
mA range	5~100mA
mAs range	0.1 ~ 320mAs
Tube	Rotating Anode Tube 0.6mm/1.8mm,40kJ
Input Power	AC100~264V, 80kHz~200kHz

collimator

collimator
43cm*43cm@SID100cm
180lux@SID100cm